

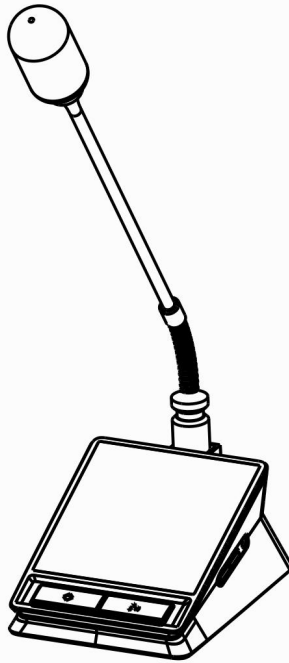

DIGITAL CONFERENCE SYSTEM CHAIRMAN UNIT Installation Manual

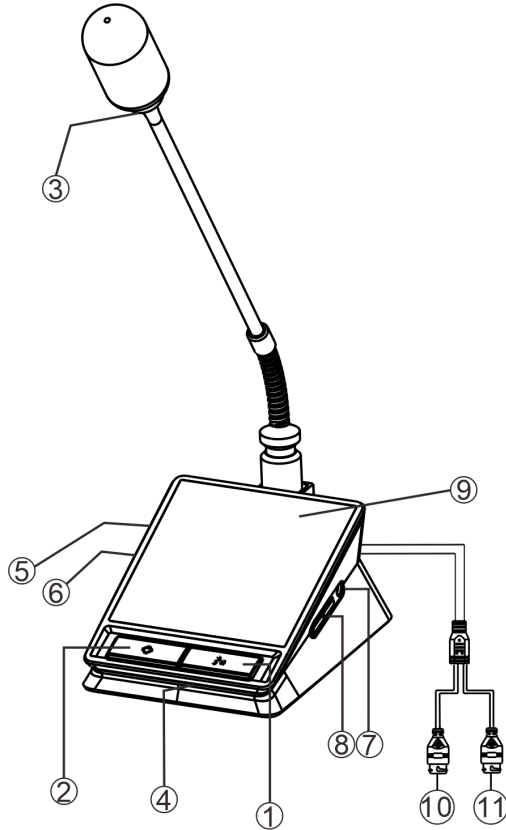

Interface Description

- ① Speak button
- ② Ban button
- ③ Microphone pole status light
- ④ Speak status light
- ⑤ Looped network status light
- ⑥ Type-C interface
- ⑦ 3.5 audio interface
- ⑧ Volume button+, -
- ⑨ Touch screen.
- ⑩ White network port: connect to the OUT port of splitter.
- ⑪ Black network port: Connect to the RANG port of splitter.

Wiring

Central Unit

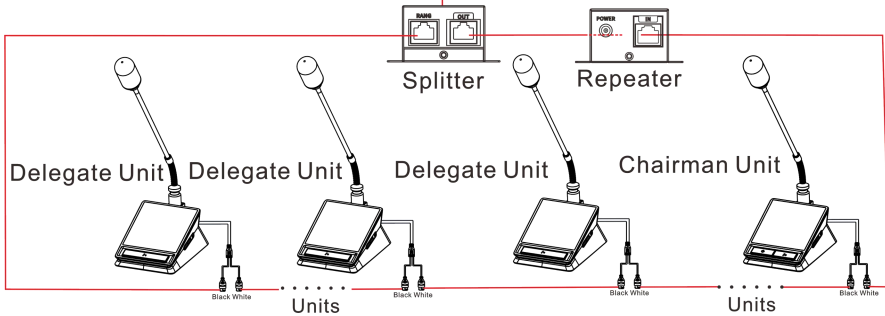
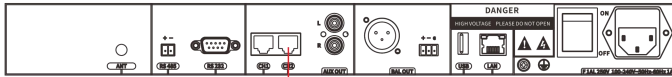

Appearance Installation Dimension Diagram (unit :mm)

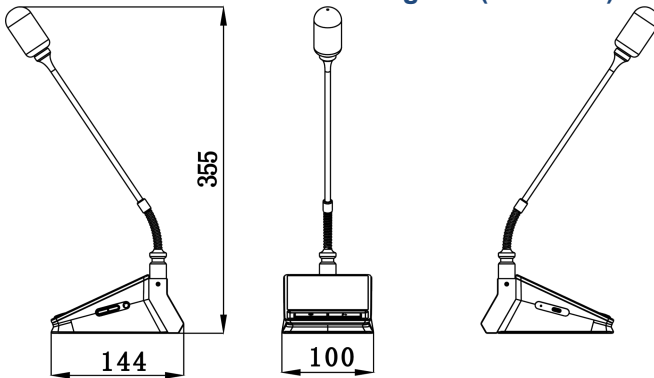

Installation Diagram

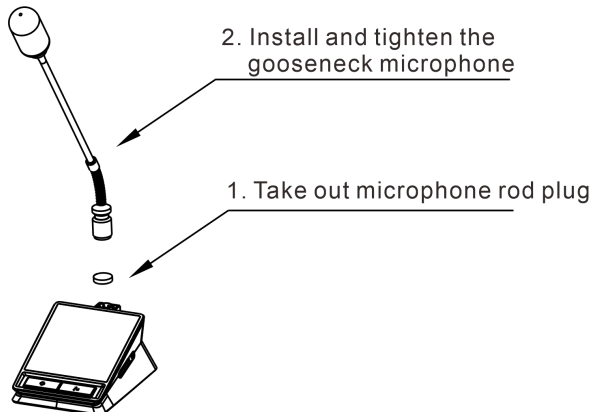

Specifications, Functional Components and Parameters

Power supply, Power consumption	Central unit supply 24V power input Chairman unit power consumption≤3.5W
Audio coding format	MP3/PCM/ADPCM
Audio sampling rate, Bit rate	8Khz-48Khz, 16bit, 8Kbps-320kbps
(SNR)Signal to noise ratio, Frequency response	≥83dB、40Hz-18KHz
Server file broadcast (SNR)signal to noise ratio, frequency response	≥90dB、40Hz-18KHz
Screen	4.3 inch Capacitive touch screen
Screen Resolution	480*480 (RGB)
Headphone output interface	∅ 3.5mm Stereo jack
Storage	Built-in SPI FLASH
Connection method	Cat6a network cable
Microphone	14mm diameter gold-plated capacitive microphone *2
Directional property	Supercardioid
Interface	RJ45 network port*2, connect to the next microphone unit
Operating temperature, Operating humidity	0-45℃, ≤90% (non condensing)
Dimension	114*100*355mm
Shell material	ABS/Aluminium Alloy

Packing List

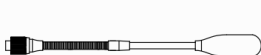

Microphone Pole
1pcs(IM-350-1)



Waterproof cotton
1pcs



Standard network
cable 1pcs(1m)



Installation
manual 1pcs



Certification
1pcs



SPON Communications Co., Ltd.
www.sponcomm.com
Service Hotline: +86-731-85570190
Reserve the amendment right without notice



VI. 3B240412