

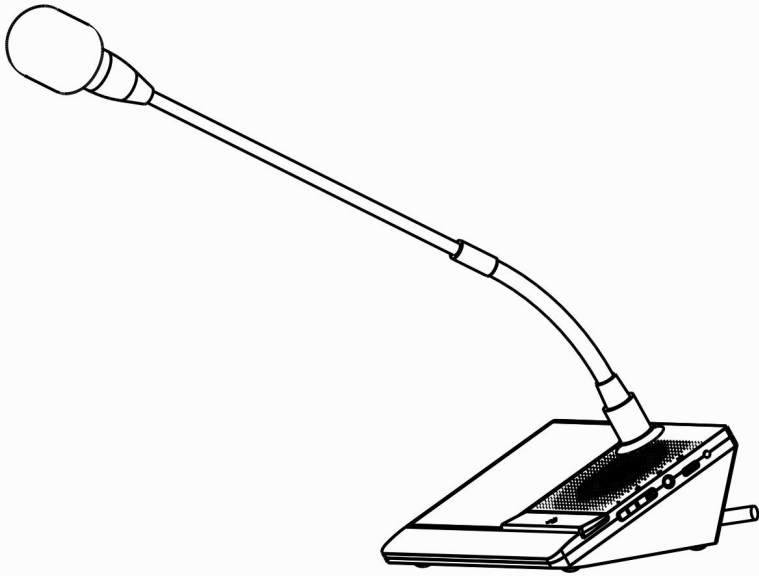

# MICROPHONE UNIT (WIRED)







## Installation Manual



## The meaning of symbols

### ■ Safety instructions

For your safe and correct use of equipment, we use a lot of symbols on the equipment and in the manuals, demonstrating the risk of body hurt or possible damage to property for the user or others. Indications and their meanings are as follow. Please make sure to correctly understand these instructions before reading the manual.

	This is A level product, which may cause radio interference in the living environment. In this case, users may need to take the feasible measures to get around the interference.
	Remind users that the dangerous voltage without insulation occurring within the equipment may cause people suffer from shock.
	CE certification means that the product has reached the directive safety requirements defined by the European Union. Users can be assured about the use of it.
	This product is RoHS compliant, adhering to the Restriction of Hazardous Substances Directive set by the European Union, ensuring the safe and environmentally friendly use of electrical and electronic equipment.
	This product passed the ISO9001 international quality certification.
	Warning: in order to avoid electrical shock, do not open the machine cover, nor is the useless part allowed to be placed in the box. Please contact the qualified service personnel.

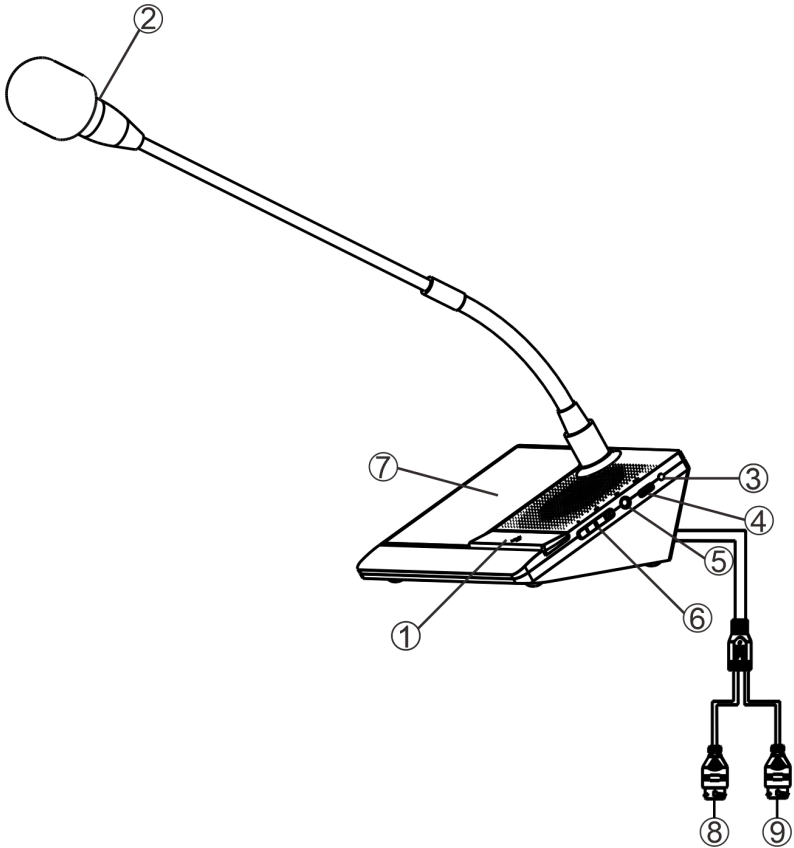
**Interface Description**

- ① Speak button
- ② Microphone pole status light
- ③ Looped network status light
- ④ Type-C interface: used for updating program.
- ⑤ 3.5mm audio interface
- ⑥ Volume button+, -
- ⑦ Touch screen
- ⑧ White network port: Connect to the OUT port of splitter.
- ⑨ Black network port: Connect to the RANG port of splitter.



**Installation Diagram**

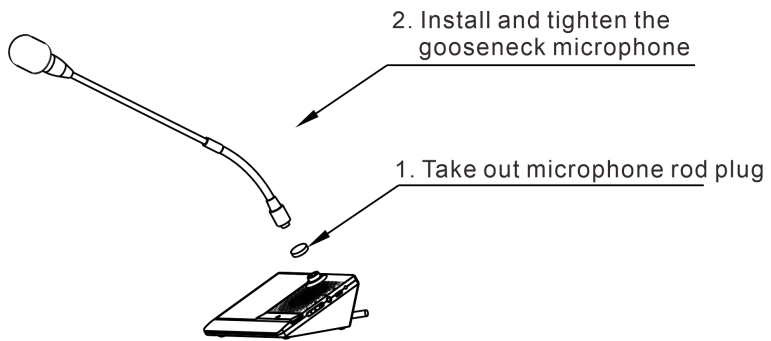

**Specifications, Functional Components and Parameters**

Power supply, Power consumption	Central unit supply 24V power input Chairman unit power consumption≤3.5W
Audio coding format	MP3/PCM/ADPCM
Audio sampling rate, Bit rate	8Khz-48Khz, 16bit, 8Kbps-320kbps
(SNR)Signal to noise ratio, Frequency response	≥83dB、40Hz-18KHz
Server file broadcast (SNR)signal to noise ratio, frequency response	≥90dB、40Hz-18KHz
Screen	4 inch capacitive touch screen
Screen Resolution	480*480(RGB)
Headphone output interface	∅ 3.5mm Stereo jack
Storage	Built-in SPI FLASH
Connection method	Cat6a network cable
Microphone	Gooseneck microphone
Directional property	Supercardioid
Interface	RJ45 network port*2, connect to the next microphone unit
Operating temperature, Operating humidity	0-45℃, ≤90%(non condensing)
Dimension	168*103*289mm
Shell material	ABS+PC

**Packing List**

Microphone Pole  
1pcs(Optional)



Windshield  
1pcs(Optional)



Installation  
manual 1pcs



Certification  
1pcs



SPON Communications Co., Ltd.  
[www.sponcomm.com](http://www.sponcomm.com)  
Service Hotline: +86-731-85570190  
Reserve the amendment right without notice



V1.1B250718